

Technical characteristics

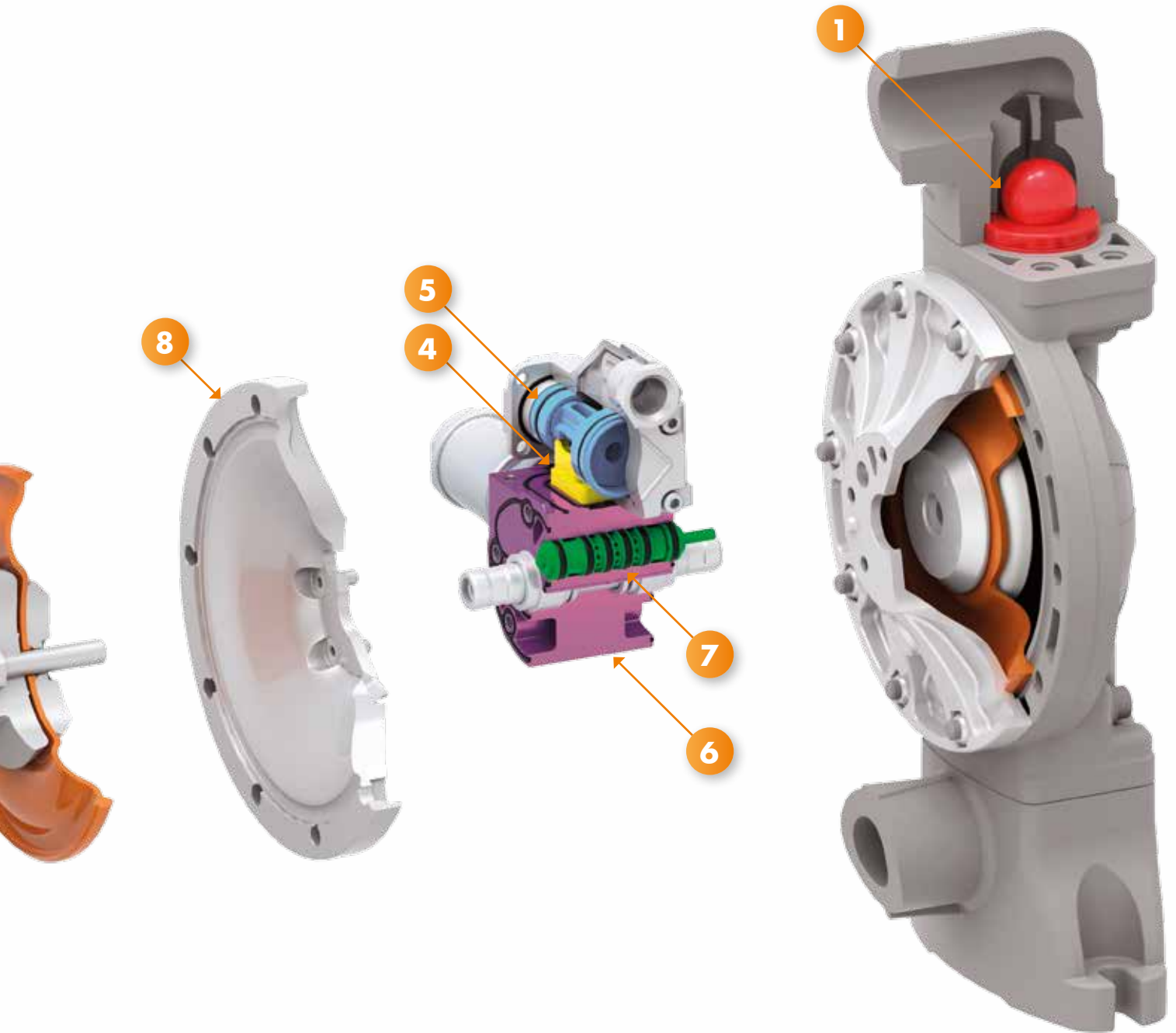

WARRANTY
5
YEARS



In accordance with
the ATEX directive

3 Membranes made with **different and specific materials** able to withstand many types of fluids and millions of cycles.

4 The air distribution valve **ensures perfect operation** in any operating conditions. Some examples:

- Minimum supply pressures (min. 2 bar)
- Critical fluid and ambient temperatures
- Supply pressure fluctuations

5 Air distributor unit equipped with **anti-stall reversing piston**. This piston prevents the pump from stopping at a dead point, even in critical operating conditions.

6 Pneumatic motor with **anti-ice device**. This allows the pump to maintain its performance, even if powered with untreated air.

7 The pneumatic motor block of the pump does not require any type of lubrication because the moving parts are **self-lubricating**.

8 Flanges created to withstand **heavy work conditions**.

9 Industrial design, material in aluminum with **internal and external sand blasting and nickel-plating surface treatment**. Die-casting ensures a better structural and surface finish.